

The 23rd Annual Scientific Meeting of Macao Radiological Technologists' Association

Conference Venue

Studio City Macao

Estrada do Istmo, Cotai, Macau

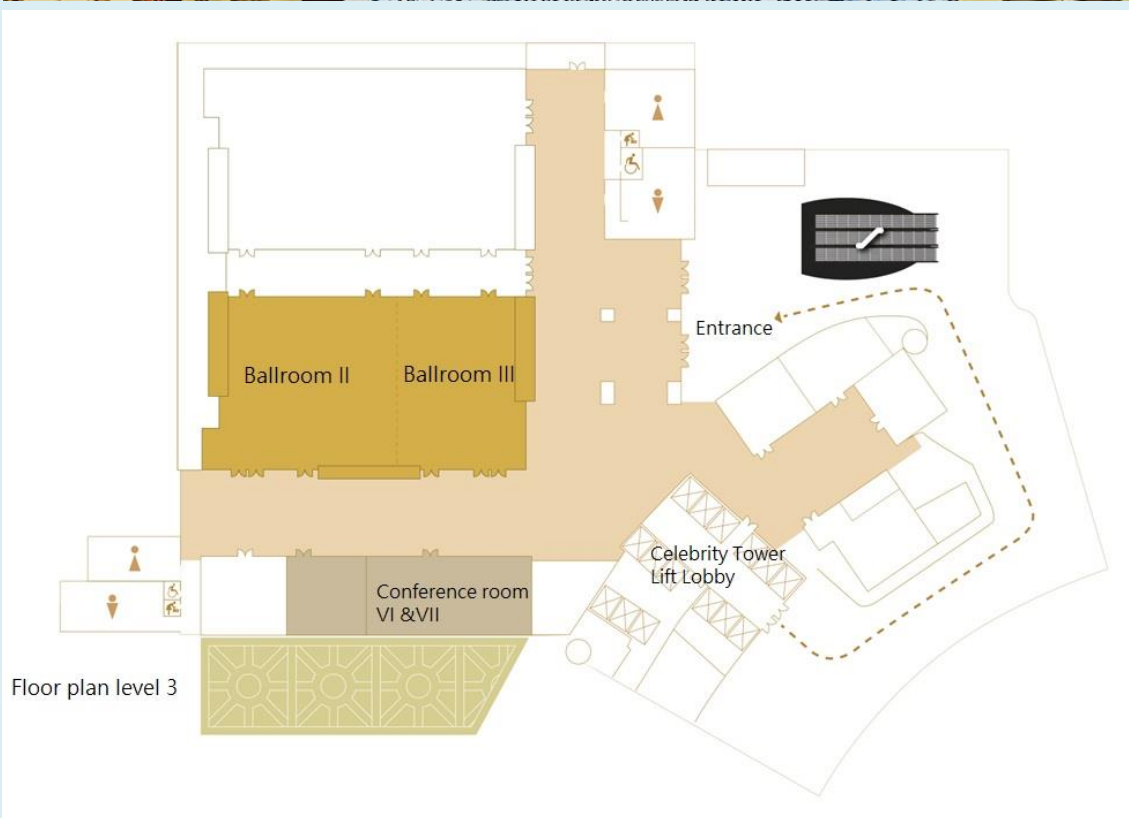

Floor plan level 3

Transportation

From Macao International Airport

Shuttle Bus

The most convenient way to travel to each hotel, including Studio City Macao, is to take any one of the many comfortable, complimentary shuttle buses from the Macao International Airport. Walk toward the north exit of the airport and walk out into the parking lot, where you will find a number of shuttle buses waiting for you.

For the shuttle bus frequency of Studio City Macao, please kindly check the table on Page 5.



LRT Service

The LRT Airport Station located on Avenida Wai Long, connects to the Macao International Airport Passenger Terminal Building North Exit.

You can get off at Lotus Checkpoint Station and exit at A exit to the Studio City Macao.



Transportation

From Hong Kong International Airport

Shuttle Bus

Macau HK Airport Direct

Macau HK Airport Direct provides the shuttle service between Hong Kong-Zhuhai-Macau Bridge (HZMB) Macau Port and Hong Kong International Airport.

Ticketing Point locates at Counter A02, Arrivals Hall A, Terminal 1

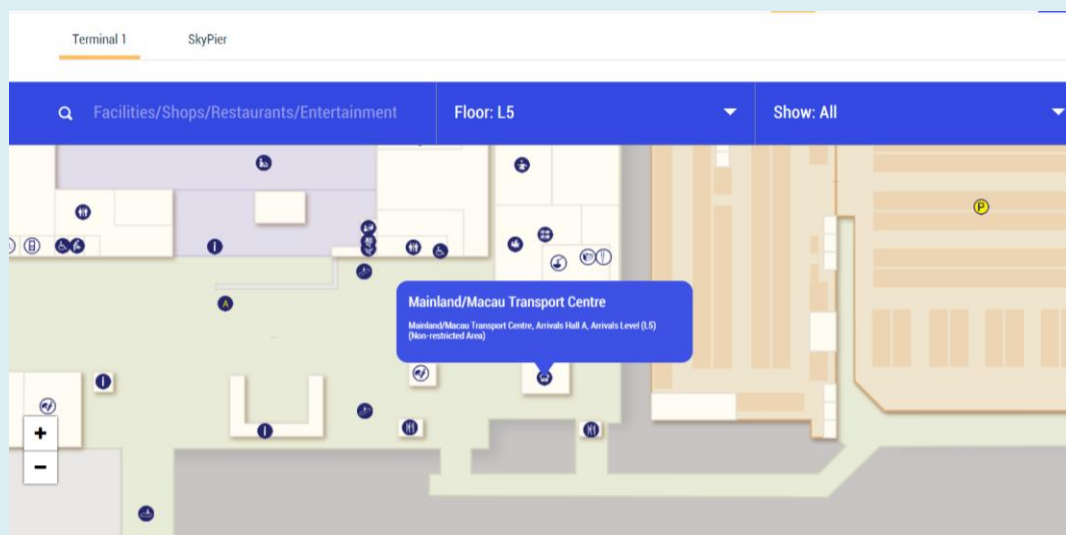

Fares:

Currency	Adult		Preferential*	
	Single Trip	Round Trip	Single Trip	Round Trip
MOP / HKD	185	370	120	240
RMB	170	340	110	220

*Remarks: Preferential fares only apply to children below 3 years old and adults over 65 years old.

For the bus frequency and other information, please visit <https://www.macauhairportbus.com/index.php?lang=en>

When you arrive the HZMB Macao Port, you can choose the hotel shuttle bus (please kindly check the bus frequency on Page 5), taxi or public bus to Macao.

Public Buses:

Line	Service Time	Route
101X	All day from Monday to Sunday	To/From: HONG KONG-ZHUHAI-MACAU (TERMINAL) Ferrira Amara! Square
102X	Monday to Sunday: 6:00-24:00	To/From: Hong Kong-Zhuhai Macau Jockey Club

Transportation

From Hong Kong International Airport

Ferry Transfer

SkyPier at Hong Kong International Airport (HKIA) provides speedy ferry services for transfer passengers.

Note: SkyPier is for transfer passengers only. It is not applicable to passengers originating from Hong Kong.

For the latest ferry schedule and ticketing arrangement, please check

<https://www.hongkongairport.com/en/transport/mainland-connection/ferry-transfer.page> .

To Mainland China & Macao:

Passengers looking to take a ferry to the Mainland China or Macao should proceed to the ferry ticketing counter at Transfer Area E2. DO NOT go through immigration and reclaim your baggage. Passengers who have gone through immigration procedures CANNOT return to the ferry ticketing counter and use the ferry service.

To use the service, passengers must:

- Possess the following items:

- Same day arrival flight air ticket / e-ticket / boarding pass stub; A valid ferry ticket and A valid passport and, if applicable, a visa for the intended destination (Mainland China / Macao)

- Transfer to Mainland China / Macao within the same day of arrival
- Arrive at the Ferries to Mainland / Macao Ticketing Counter located at Transfer Area E2 at least 90 minutes before the scheduled ferry departure time for ticketing and transfer procedures. For passengers without checked baggage, 30 minutes would be sufficient;
- For passengers with checked baggage, please present the airline baggage tag receipt for customs clearance and baggage transfer procedures.

View this [flow chart](#) outlining the required steps.

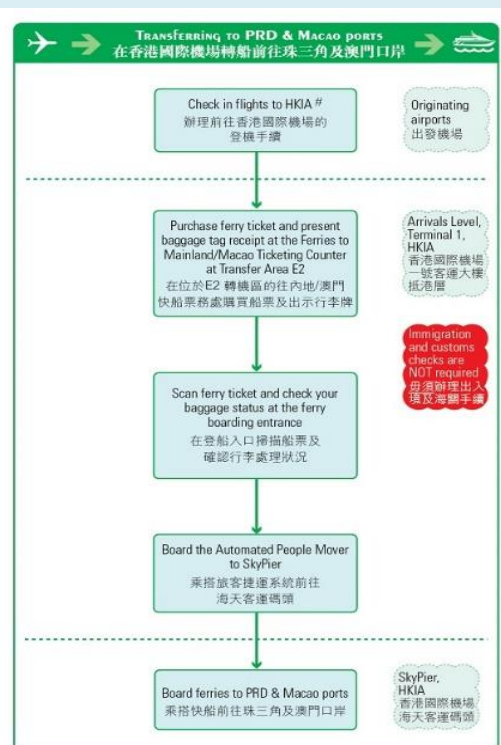

Some airlines provide baggage tag through service which sends baggage directly to the PRD & Macao ports. For participating airlines and service details, please contact airlines or ferry operators or visit HKIA website.
部分航空公司提供行李直掛服務，將行李直接送到珠三角及澳門口岸。查詢參與航空公司及服務詳情，請與航空公司或快船營運商聯絡或瀏覽香港國際機場網頁。

Studio City Macao - Free Shuttle Bus (Monday to Friday)

Locations	From Studio City	To Studio City	Frequency
Border Gate	10:05 - 22:15	9:30 - 21:30	10 - 15 mins
Macao Ferry Terminal	10:15 - 21:50	9:30 - 21:45	15 - 20 mins
Macao International Airport	10:15 - 21:50	9:50 - 22:05	15 - 20 mins
Taipa Ferry Terminal	10:15 - 21:50	9:45 - 22:00	15 - 20 mins
HZMB Macau Port	10:45 - 21:55	10:00 - 21:10	20 - 30 mins
Hengqin Border	10:30 - 19:30	10:00 - 19:45	45 mins
City of Dreams	9:45 - 21:45	10:05 - 21:05	10 - 15 mins
Altira	11:15 - 20:55	10:50 - 21:20	40 - 50 mins

Studio City Macao - Free Shuttle Bus (Saturday to Sunday)

Locations	From Studio City	To Studio City	Frequency
Border Gate	10:05 - 22:15	9:30 - 21:30	10 - 15 mins
Macao Ferry Terminal	10:15 - 22:15	9:30 - 21:45	15 -20 mins
Macao International Airport	10:15 - 21:50	9:50 - 22:05	15 -20 mins
Taipa Ferry Terminal	10:15 - 22:15	9:45 - 22:00	15 -20 mins
HZMB Macau Port	10:45 - 21:55	10:00 - 21:10	20 - 30 mins
Hengqin Border	10:30 - 19:30	10:00 - 19:45	45 mins
City of Dreams	9:45 - 21:45	10:05 -21:05	10 - 15 mins
Altira	11:15 - 20:55	10:50 - 21:20	40 - 50 mins

Public Buses in Macao

Guests can download the “Bus Traveling System  from the App store to get more information about each route.

Around Studio City Macao

